

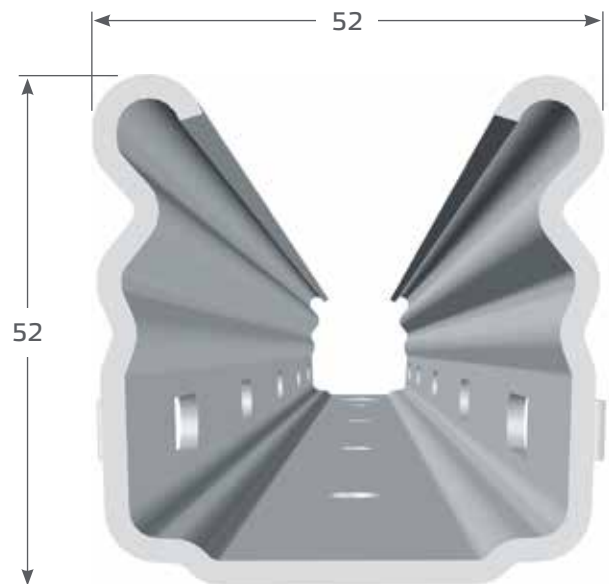

P5E Profile

The P5E end post provides the best solution for all systems:

- Large pull out hole
- Attachment holes in the back wall for a centre tensioning of fixed wires
- Holes at ground level for the base plate
- Attach end posts to the base plate using a simple plug system
- Options for attaching any type of brackets for chains
- Lateral hooks can be used to attach and tension wires
- Available in four thicknesses:
 - up to 80 m row length with 1.65 mm thickness
 - over 80 m row length with 2.15 mm thickness in HDG
 - over 150 m row length with 2.65 mm thickness.
 - 2 mm thick for strip galvanised Z350



The open side of the profile must face the anchor point.

Our posts are available in 3 different types:

- Hot Dipped Galvanised
- Strip Galvanised (Z350)
- Weathering steel

P5E Configuration table

Hooks	Post length [cm]							
	140	160	180	200	230	250	275	300
	Number of pairs of hooks							
S-hook	8	8	10	12	14	14	14	16
Total number of pairs of hooks	8	8	10	12	14	14	14	16

P5E installation depth table

Post length [cm]	Recommended installation depth [cm]
140	40-45
160	50
180	55
200	60-65
230	70
250	70-75
275	85
300	95

The end post should always be installed approximately 10-20 cm deeper than the first or last intermediate post.



P5E Profile

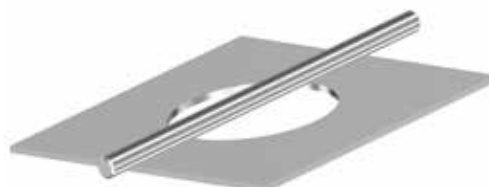

Profil Alsace S.A.S.
Zone Industrielle Kiesweg
F-67630 Niederlauterbach

Tel.: +33 (0) 3 88 94 68 88
Fax: +33 (0) 3 88 94 68 85
E-Mail: info@profilalsace.com
www.profilalsace.com



Website



Youtube